

WM Liquid Wafer Style Turbine Flow Meter

**ACCURATE AND RELIABLE
LIQUID FLOW METERING**

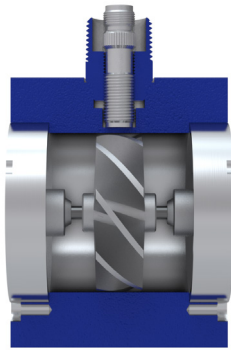

Turbines, Inc. is the leader in the design and manufacture of reliable and accurate turbine flow metering equipment, electronic monitors, and accessories. All products are engineered, manufactured, and calibrated using premium quality materials by skilled tradesman with state-of-the-art equipment. Turbines, Inc. maintains a team of dedicated engineers, technicians, and application specialists, who are on-call to assist with product/application guidance, technical assistance, and special configurations or modifications.

Specifications	
Performance	
Linearity	+/- 1.0% over flow range*
Repeatability	+/- 0.1% over flow range
Operating Temperature	-100° F to +300° F Standard (850° F with special coil)
Maximum Pressure	Up to 6,170 PSI
Materials	
Meter Body	316 Stainless steel
Rotor Supports	316 Stainless steel
Meter Rotor	CD4MCu / 416 Stainless steel
Rotor Shaft	Tungsten carbide
Bearings	Tungsten carbide
Additional Information	
Full line of Retrofit Kits are available Factory refurbishment is available	
Connections	Between customer specified flanges
Certifications	CRN Certified, NIST traceable calibration

Performance Specifications

Turbines Part Number	End Connection Size (in)	Flow Range (GPM)	Flow Range (BPD)	Flow Range (M3PD)	Flow Range (LPM)	Accuracy/ Repeatability	Repair Kits (Kits come with: 2-Rotor Supports, 1-Rotor & 2-Retaining rings, or replacement screws)
WM0038X1 WM0038X2	3/8" x 1" 3/8" x 2"	0.3 - 3	10 - 100	1.6 - 16	1.14 - 11.36	+/-2.0% +/-0.1%	WK0038X1 WK0038X2
WM0050X1 WM0050X2	1/2" x 1" 1/2" x 2"	0.75 - 7.5	25 - 250	4 - 40	2.84 - 28.39	+/-1.0% +/-0.1%	WK0050X1 WK0050X2
WM0075X1 WM0075X2	3/4" x 1" 3/4" x 2"	2 - 15	68 - 514	11 - 80	2.84 - 28.39	+/-1.0% +/-0.1%	WK0075X1 WK0075X2
WM0078X1 WM0078X2	7/8" x 1" 7/8" x 2"	3 - 30	102 - 1,028	16 - 160	11.36 - 113.6	+/-1.0% +/-0.1%	WK0078X1 WK0078X2
WM0100X1 WM0100X2	1" x 1" 1" x 2"	5 - 50	170 - 1,700	27 - 270	18.93 - 189.3	+/-1.0% +/-0.1%	WK0100X1 WK0100X2
WM0150X2	1-1/2" x 2"	15 - 180	514 - 6,000	80 - 980	56.8 - 681.35	+/-1.0% +/-0.1%	WK0150X2
WM0200X2	2" x 2"	40 - 400	1,371 - 13,714	218 - 2,180	151 - 1,514	+/-1.0% +/-0.1%	WK0200X2
WM0300X3	3" x 3"	60 - 600	2,100 - 21,000	320 - 3,200	227 - 2,270	+/-1.0% +/-0.1%	WK0300X3
WM0400X4	4" x 4"	120 - 1,200	4,100 - 41,000	654 - 6,541	454 - 4,542	+/-1.0% +/-0.1%	WK0400X4
WM0600X6	6" x 6"	250 - 2,500	8,571 - 85,710	1,090 - 13,627	946 - 9,463	+/-1.0% +/-0.1%	WK0600X6
WM0800X8	8" x 8"	350 - 3,500	12,000 - 120,000	1,907 - 19,080	1,324 - 13,248	+/-1.0% +/-0.1%	WK0800X8
WM1000X10	10" x 10"	550 - 5,500	19,000 - 190,000	2,998 - 29,980	2,081 - 20,819	+/-1.0% +/-0.1%	WK1000X10

Magnetic pick up is standard on all models (no extra charge) *except WM0038 which is +/- 2.0%

Service

Our dedicated staff offers complete support and recertification for flow meters — whether our own or a competitor's brand. Our calibration services are performed by our trained technicians using the latest testing equipment.

Turbines, Inc. maintains extensive inventories in multiple locations to facilitate rapid, industry leading deliveries.

Worldwide Support

We serve customers globally with offices in Altus, OK; Seneca, SC; Odessa, TX; Cranston, RI; and Edmonton, Alberta, Canada.



All Turbines, Inc. products are proudly made in the U.S.A.



15935 Highway 283 N.
Altus, Oklahoma 73522, USA
Tel: +1-580-477-3067
www.turbinesincorporated.com



112 Lumber Ln.
Seneca, SC 29672 USA
Tel: +1-864-882-4544
www.turbinesincorporated.com



960 South Meadow Ave.
Odessa, TX 79761 USA
Tel: +1-432-333-4800
www.turbinesodessa.com



800 Wellington Avenue
Cranston, RI 02910, USA
Tel: +1-401-461-6366
www.primaryflowsignal.com



2236 80th Avenue NW,
Edmonton, AB T6P 1N2
Tel: 877-661-3569
www.pfscanada.ca