

# ITM – Integrated Turbine Meter

**HIGHLY ACCURATE AND RELIABLE  
LIQUID MEASUREMENT**



**Turbines, Inc.** is the leader in the design and manufacture of reliable and accurate turbine flow metering equipment, electronic monitors, and accessories. All products are engineered, manufactured, and calibrated using premium quality materials by skilled tradesman with state-of-the-art equipment.

Turbines, Inc. maintains a team of dedicated engineers, technicians, and application specialists, who are on-call to assist with product/application guidance, technical assistance, and special configurations or modifications.

## Specifications

<b>Performance</b>	
Linearity	+/- 1.0% over standard flow range
Repeatability	+/- 0.1% over standard flow range
Operating Temperature	-22° F to +150° F
Flow Rate	3 to 30 gpm 5 to 50 gpm
<b>Materials</b>	
Meter Body	316 Stainless steel
Rotor Supports	316 Stainless steel
Meter Rotor	7/8" 416 Stainless steel 1" CD4MCu
Rotor Shaft	Tungsten Carbide
Sleeve Bearings	Tungsten Carbide
<b>Additional Information</b>	
Full line of calibrated, Retrofit Kits are available Factory refurbishment is available UV Resistant Enclosure PA66 GF20	
Connection	1" FNPT
<b>Certifications</b>	
ISO9001, NIST traceable calibration, IP67	



## General Arrangement

Meter Size	A in (mm)	B in (mm)	C in (mm)	D End Fitting
7/8"	2.375 (60.33)	2.86 (72.6)	5.50 (139.7)	1" FNPT
1"	2.375 (60.33)	2.86 (72.6)	5.50 (139.7)	

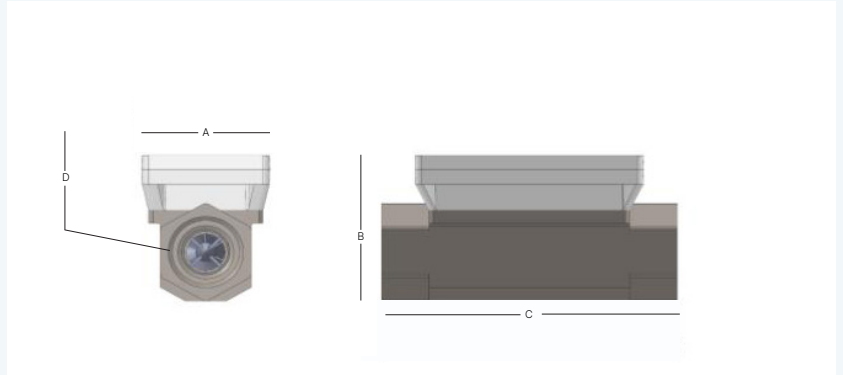

Nominal Flow Range Gallons (Liters) Per Minute		
Meter Size	Minimum Linear	Maximum Linear
7/8"	3 (11.3)	30 (113)
1"	5 (18.9)	50 (189)

Electronics	
Total Display	Accumulative and Batch
Readout Totals	8 Digits
Decimal Locations	0, 1, 2, X10, X100
Total Units	Gallons (GAL), Liters (LIT), Cubic Meters (M3), Custom
Rate Display	
Readout Rate	6 Digits
Decimal Locations	0, 1, 2, X10, X100
Rate Units	Seconds (/S), Minute (/M), Hour (/H), Day (/D)

## Service

Our dedicated staff offers complete support and recertification for flow meters — whether our own or a competitor's brand. Our calibration services are performed by our trained technicians using the latest testing equipment.

Turbines, Inc. maintains extensive inventories in multiple locations to facilitate rapid, industry leading deliveries.

## Worldwide Support

We serve customers globally with offices in Altus, OK; Seneca, SC; Odessa, TX; Cranston, RI; and Edmonton, Alberta, Canada.



**Turbines, Inc. products are proudly made in the U.S.A.**



15935 Highway 283 N.  
Altus, Oklahoma 73522, USA  
Tel: +1-580-477-3067  
[www.turbinesincorporated.com](http://www.turbinesincorporated.com)



112 Lumber Ln.  
Seneca, SC 29672 USA  
Tel: +1-864-882-4544  
[www.turbinesincorporated.com](http://www.turbinesincorporated.com)



960 South Meadow Ave.  
Odessa, TX 79761 USA  
Tel: +1-432-333-4800  
[www.turbinesodessa.com](http://www.turbinesodessa.com)



800 Wellington Avenue  
Cranston, RI 02910, USA  
Tel: +1-401-461-6366  
[www.primaryflowsignal.com](http://www.primaryflowsignal.com)



2236 80th Avenue NW,  
Edmonton, AB T6P 1N2  
Tel: 877-661-3569  
[www.pfscanada.ca](http://www.pfscanada.ca)